

# EPS Focus Whole House Fan Installation Instructions



Parts List *		Quantity
1	Fan Assembly	(1)
2	Fan Grill	(1)
3	Power Cord	(1)
4	Remote Control	(1)
5	Extension Cable 30 ft. (Sold Separately)	(1)

## Required Tools:

Saber, Reciprocating or Keyhole Saw

Utility Knife

Drywall Circle Cutter

Tape Measure

Screw Gun with Phillips Head

Electronic or Magnetic Stud Finder

Required Safety Equipment

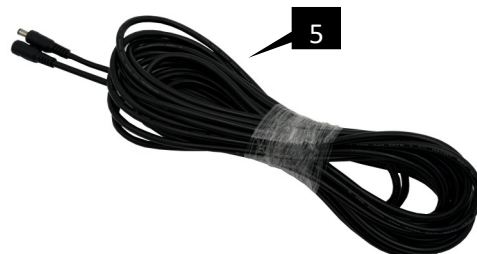



# WARNING



**Do not proceed with the installation until you have read the entire instructions, including these warnings. Use of materials or methods not authorized by Solatube International will result in an invalid warranty.**

Solatube International, Inc. (seller) assumes no responsibility or obligation whatsoever for the failure of an architect, contractor, installer, or building owner to comply with all applicable laws, ordinances, building codes, electrical codes, energy codes, fire and safety codes and requirements, roof warranties and adequate safety precautions. Installation of this product should be attempted only by individuals skilled in the use of the tools and equipment necessary for installation. Protect yourself and all persons and property during installation. If you have any doubt concerning your competence or expertise, consult a qualified expert before proceeding. **Deviation from these instructions in any manner, including application and mounting, will result in a voided warranty.**

## Install at your own risk!



Solatube product installations may be dangerous and include the potential for death, personal injury and property damage. The hazardous conditions include but are not limited to the following:

- Solatube Daylighting Systems, Solar Star products, and Whole House Fan ventilation systems may have sharp edges. Always wear leather or canvas gloves while handling and installing products.
- Solatube product installations require climbing and working at dangerous heights, including on ladders, scaffolding, roofs and in attic spaces. Risk of death, personal injury and property damage may result from a fall, or from falling objects. Use extreme caution to minimize risk of accidental injury, including, but not limited to the following procedures:
  - Clear area below your work space of all people, animals and other items.
  - Avoid working on surfaces that are slippery or wet.
  - Use foot-wear with excellent traction.
  - Use only strong, well supported ladders.
  - Work only in calm dry weather.
  - When in the attic, ensure that your weight is supported at all times with structurally sound framing; drywall material is not designed to carry a person's weight.
- To reduce the risk of fire, electric shock, and personal injury, basic safety precautions should always be followed when using electric tools, including always wearing safety goggles or other suitable eye protection, and ensuring work area is clear of all electrical wires, gas pipes, water pipes, and other obstacles.
- When working in the attic or other dusty areas, use of a mask or respirator is recommended to avoid lung irritation. Attic spaces may be dark, confined, and subject to extreme temperatures. Beware of sharp protruding objects. Do not attempt installation without having someone within range of your voice or close enough to come to your aid if necessary.
- Solatube products are not designed to withstand the weight of a person, tools or other objects. Walking or placing objects on the system could cause personal injury and property damage. If the product is damaged, the structural capacity may be weakened; therefore the system should be repaired immediately. For safe installation and use, do not deviate from these installation instructions.



## Whole House Fan Installation Tips

These instructions are a step-by-step guide for the installation of Solatube Whole House Fan ventilation products in the following conditions.  
**PLEASE READ AND SAVE THESE INSTRUCTIONS**

## WARNING

**To Reduce The Risk Of Fire Or Electric Shock, Do Not Use This Fan With Any Solid-State Speed Control Device. Electrical Connections Should Only be Performed By A Licensed Electrician.**

### To Reduce The Risk Of Fire, Electric Shock, Or Injury To Persons, Observe The Following:

- Use this unit only in the manner intended by the manufacturer. If you have questions, please contact your Solatube International representative.
- Before servicing or cleaning unit, switch power off at service panel and lock the service disconnecting means to prevent power from being switched on accidentally. When the service disconnecting means cannot be locked, securely fasten a prominent warning device, such as a tag, to the service panel.

### Caution

- For General Ventilation Use Only. Do Not Use To Exhaust Hazardous or Explosive Materials and Vapors.
- Installation work and electrical wiring must be done by qualified persons (s) in accordance with all applicable codes and standards, including fire rated construction.
- Sufficient air is needed for proper combustion and exhausting of gases through the flue (chimney) of fuel burning equipment to prevent back drafting. Follow the heating equipment manufacturer's guidelines and safety standards such as those published by the National Fire Protections Association (NFPA), and the American Society for Heating, Refrigeration and Air Conditioning Engineers (ASHRAE), and local code authorities.
- When cutting or drilling into wall or ceiling, do not damage electrical wiring and other hidden utilities.

For the most current Installation Instructions, please visit [www.solatube.com/instructions](http://www.solatube.com/instructions)

Solatube International, Inc. | 2210 Oak Ridge Way | Vista, CA 92081-8341 | [www.solatube.com](http://www.solatube.com) | T: 888.SOLATUBE

## Overview

Locate Desired Placement of the EPS Focus Whole House Fan.

The Focus Whole House Fan is intended for smaller rooms and bedrooms. Select a location that has adequate inlet ventilation such as a window. For best experience, choose a location away from windows to help create a cross breeze.

**NOTE:** The attic must be large enough to accommodate the Whole House Fan in the chosen location. There must be a minimum vertical clearance of 20 inches from top of ceiling to roof rafter. Also, the attic must have accessible power close enough to be able to plug in the fan. If power is not close enough to fan installation, a 30 ft. extension cable is available.

**NOTE:** Please ensure that there is adequate net free ventilation for the EPS Focus Whole House Fan. You will need one (1) square foot of net free vent area for every 750 CFM of fan capacity.



### WARNING

Avoid back drafting of combustion appliances (i.e. gas fired water heaters and gas fired furnaces) by ensuring adequate ventilation is available and properly maintained. It is recommended to test the ventilation system to ensure intake and outlet ventilation is properly balanced. In some cases, it may be necessary to increase the number of vents to achieve this.

1

#### Mark Ceiling and cut ceiling location

Using a stud finder, locate ceiling joist near desired fan location and mark location between joists. Use a drywall circle cutter mark a 14 3/4 inch round opening. Use a keyhole saw to cut ceiling opening. Remove and discard cut piece.



Choose desired location that is between ceiling joists

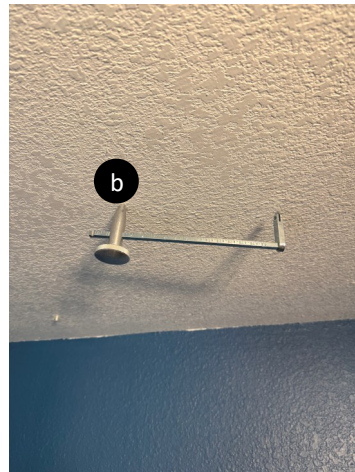

Mark location with circle cutter



Cut marked location



Discard cut piece



Plug power cord into outlet in attic.  
Run receiver end of cord to cut ceiling opening.

Note: A 30 ft. extension cable is available if longer distance is needed.

For the most current Installation Instructions, please visit [www.solatube.com/instructions](http://www.solatube.com/instructions)  
Solatube International, Inc. | 2210 Oak Ridge Way | Vista, CA 92081-8341 | [www.solatube.com](http://www.solatube.com) | T: 888.SOLATUBE



2

## Insert Fan Into Ceiling



Pull receiver cord through ceiling opening and insert receiver cord into fan



Insert fan assembly into ceiling opening



Damper doors will be visible. Adjust fan to desired location of damper doors



Use screw gun engage the four (4) fastening clamps to secure fan to ceiling



3

### Install Intake Grate



Align intake grate tabs with ceiling ring

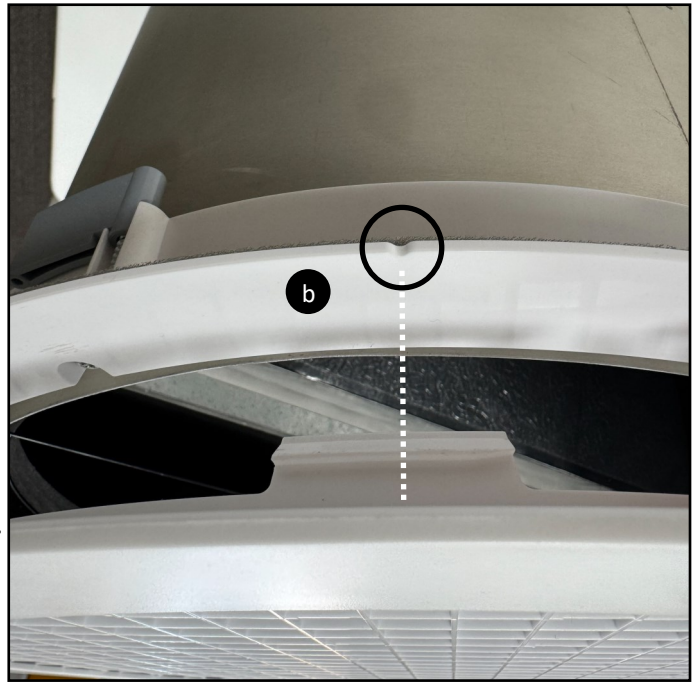

Push intake grate into ceiling ring and twist clockwise to secure

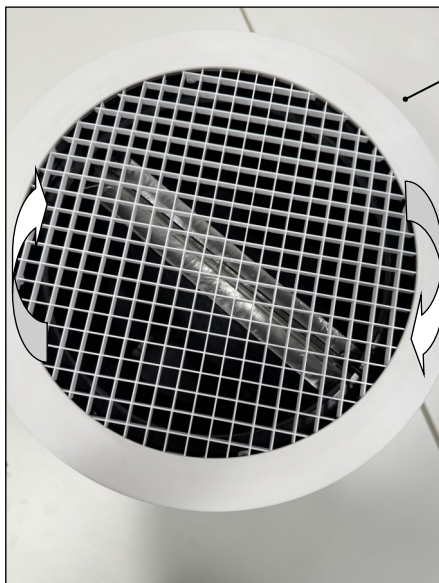

Damper doors are visible when intake grate is installed. Rotate intake grate to desired location.

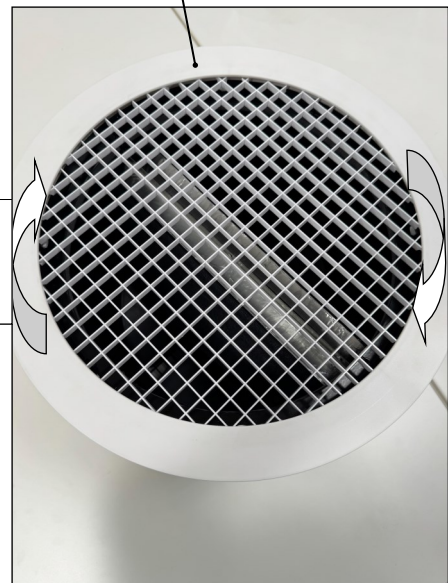



# Mount Remote to Wall (Optional)

The remote control can be left on counter or table, or can be fastened to a wall.



Remove remote from wall plate

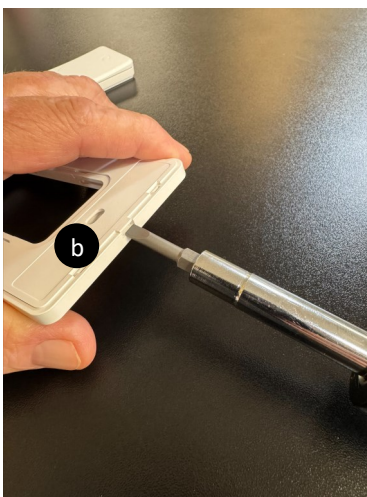

Use screwdriver to separate front of wall plate

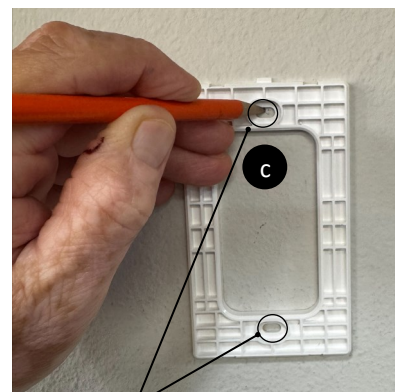

Place wall plate on desired wall location and mark fastening openings

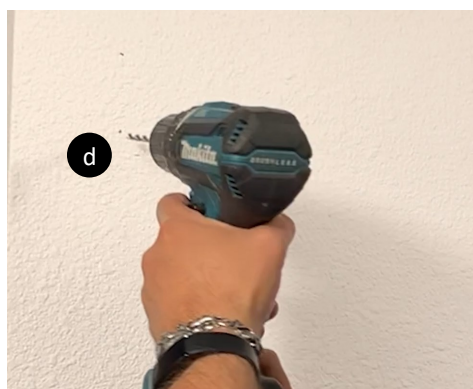

Drill marked fastener locations

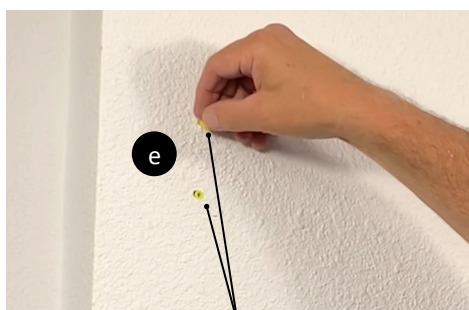

Insert wall anchors into drilled holes



Place wall plate over wall anchors and fasten to wall



Place cover over wall plate and press to snap into place

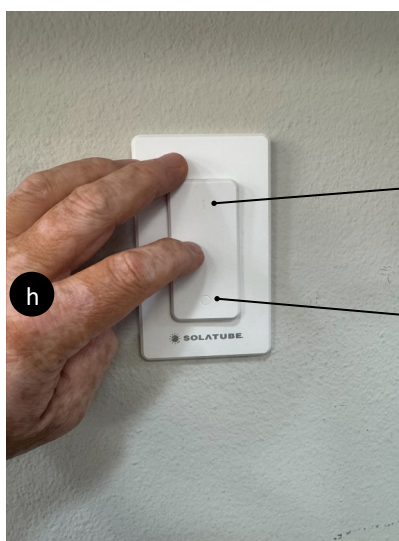

Insert remote onto wall plate to secure

To operate Focus Whole House Fan, press top of remote to start.

To turn off Focus Whole House Fan, press bottom of remote.

5

### Pairing Remote

Remotes are factory paired. If remote falls out of pairing, follow these steps.

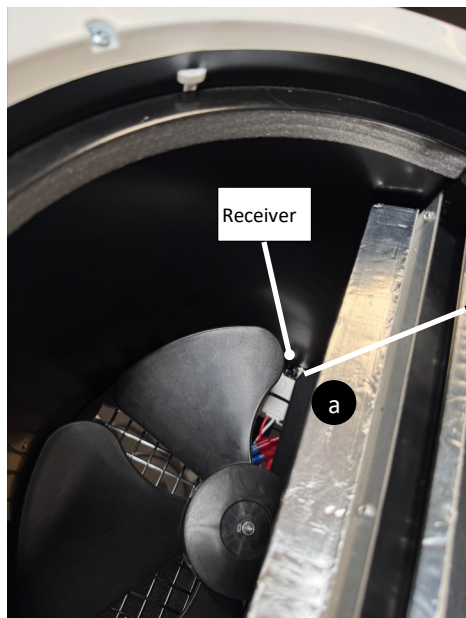

Locate receiver inside of fan housing



Press receiver button and hold for 3 seconds until red light begins flashing.

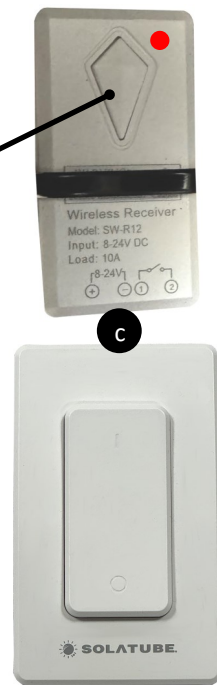

Once receiver light is flashing, press remote button to pair. Receiver light will stop flashing once paired

6

### Replace Remote Battery

Use 2032 cell battery

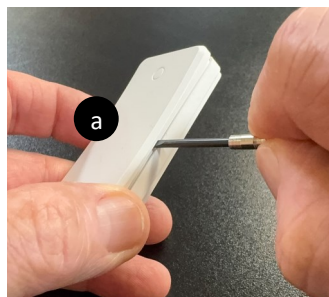

Use small flat screwdriver to remove cover from remote.

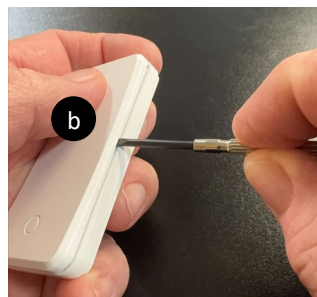

Set cover aside

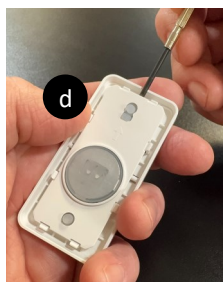

Use same screwdriver to remove internal cover



Set cover aside



Remove rubber battery cover



Set cover aside



Carefully remove battery using same screwdriver



Replace battery and reassemble remote



Solatube International, Inc.,  
2210 Oak Ridge Way, Vista CA 92081-8341  
Phone (800) 966-7652 • Fax (760) 599-5181  
**[www.solatube.com](http://www.solatube.com)**    Part No. 951903    v1.0